

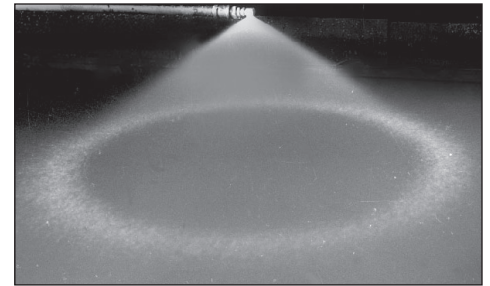

CWM.5L SERIES SPRAY NOZZLES

HOLLOW CONE • THREADED CONNECTION

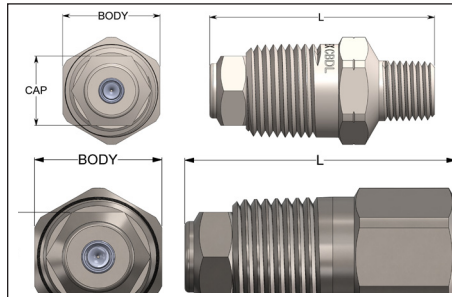

SPRAY CHARACTERISTICS:

CWM.5L series hydraulic atomizing nozzles are designed and precision machined to provide a very fine hollow-cone spray using only the liquid pressure for atomizing. Easy disassembly/assembly and cleaning. Standard spray angle is 150° at 40 PSI.

CONSTRUCTION:

1/2" male wall mount body with removable cap, orifice insert, core, core retainer and strainer. The orifice, insert, core, and strainer are supplied in 316 stainless steel standard.

TYPICAL APPLICATIONS:

- Humidification/Moisture Addition
- Evaporative Cooling
- Steam De-superheating

Model Number	"L"	BODY	CAP
1/4FCWM.5L	1 7/8	13/16 HEX	5/8 HEX
1/4CWM.5L	2 1/32	13/16 HEX	5/8 HEX



Model #		Capacities at Various Pressures USGPH								
Female	Male	30 psi	40 psi	80 psi	100 psi	200 psi	300 psi	500 psi	700 psi	1000 psi
1/4FC5.9M1/2WL	1/4C5.9WM1/2L	1.59	1.83	2.59	2.89	4.1	5.0	6.5	7.7	9.2
1/4FC7.4M1/2WL	1/4C7.4WM1/2L	1.99	2.30	3.2	3.6	5.1	6.3	8.1	9.6	11.5
1/4FC9.2M1/2WL	1/4C9.2WM1/2L	2.47	2.85	4.0	4.5	6.4	7.8	10.1	11.9	14.3
1/4FC12M1/2WL	1/4C12WM1/2L	3.2	3.7	5.3	5.9	8.3	10.2	13.2	15.6	18.6
1/4FC14M1/2WL	1/4C14WM1/2L	3.8	4.3	6.1	6.9	9.7	11.9	15.4	18.2	21.7
1/4FC18M1/2WL	1/4C18WM1/2L	4.8	5.6	7.9	8.8	12.5	15.3	19.7	23.4	27.9
1/4FC23M1/2WL	1/4C23WM1/2L	6.2	7.1	10.1	11.3	16.0	19.5	25.2	29.9	36
1/4FC28M1/2WL	1/4C28WM1/2L	7.5	8.7	12.3	13.7	19.4	23.8	30.7	36	43

