

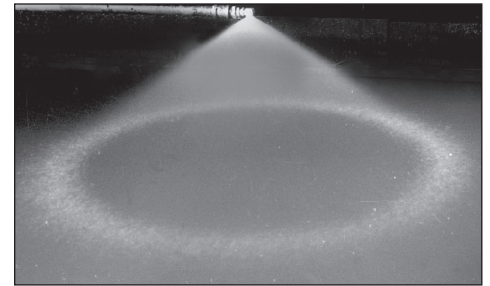

CWL SERIES SPRAY NOZZLES

HOLLOW CONE • THREADED CONNECTION

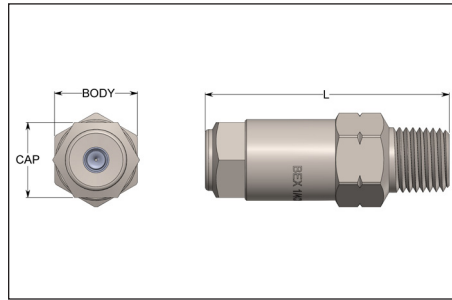

SPRAY CHARACTERISTICS:

CWL series wide angle hydraulic atomizing nozzles are precision machined to provide a very fine wide angle hollow-cone spray using only the liquid pressure for atomizing. Easy disassembly/assembly and cleaning. Standard spray angle is 150° at 40 PSI.

CONSTRUCTION:

Two piece body with removable cap, core and strainer. Bodies are available in a variety of materials. The cap, core, and strainer are supplied in 316 stainless steel standard.

TYPICAL APPLICATIONS:

- Humidification/Moisture Addition
- Evaporative Cooling
- Steam De-superheating



Model #		Capacities at Various Pressures USGPH								
Female	Male	30 psi	40 psi	80 psi	100 psi	200 psi	300 psi	500 psi	700 psi	1000 psi
1/4FC5.9WL	1/4C5.9WL	1.59	1.83	2.59	2.89	4.1	5.0	6.5	7.7	9.2
1/4FC7.4WL	1/4C7.4WL	1.99	2.30	3.2	3.6	5.1	6.3	8.1	9.6	11.5
1/4FC9.2WL	1/4C9.2WL	2.47	2.85	4.0	4.5	6.4	7.8	10.1	11.9	14.3
1/4FC12WL	1/4C12WL	3.2	3.7	5.3	5.9	8.3	10.2	13.2	15.6	18.6
1/4FC14WL	1/4C14WL	3.8	4.3	6.1	6.9	9.7	11.9	15.4	18.2	21.7
1/4FC18WL	1/4C18WL	4.8	5.6	7.9	8.8	12.5	15.3	19.7	23.4	27.9
1/4FC23WL	1/4C23WL	6.2	7.1	10.1	11.3	16.0	19.5	25.2	29.9	36
1/4FC28WL	1/4C28WL	7.5	8.7	12.3	13.7	19.4	23.8	30.7	36	43

